

Ø 30 heads:

Baco simplifies your choice



--- **AA** --- definition of **function**

T16 AA --- choice of **bezel**

T16 AA **02** colour of head

▶ HEAD COLOUR CODES

- | | |
|------------|-------------|
| o1 ● red | o4 ● yellow |
| o2 ● green | o5 ○ white |
| o3 ● black | o6 ● blue |

▶ BEZEL CODES

- T11 chrome brilliant plastic
- T12 black plastic
- T13 grey plastic
- T14 Chrome brass
- T16 Matt chrome plastic

▶ AVANTAGES

- Ø 30 heads use the same clips and blocks as Ø 22 heads
- Fully compatible with the new Ø 22 range
- Wide choice of bezels

Separate units \varnothing 30: Heads

IP 65

To be combined with a clip and electrical blocks (p. 48)

With locking ring

Plastic chrome bezel- Other bezel on request (form p. 117)

\varnothing 30 blocks use the same blocks and clips (except for the 5 position clip) as \varnothing 22 mm heads (see p. 48-65)

Conform to IEC 60947-5-1



Characteristics (p. 121)

► PUSH-BUTTONS - NON ILLUMINATED

SPRING RETURN - FLUSH

Cat. No.



T16AA01

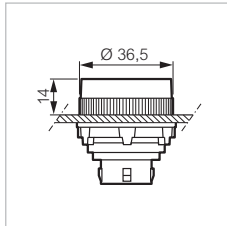

Without engraving

- Red
- Green
- Black
- Yellow
- White
- Blue

T16AA01
T16AA02
T16AA03
T16AA04
T16AA05
T16AA06

With engraving

- Red
- Green
- Black

T16AA81
T16AA82
T16AA83

SPRING RETURN - FLUSH

Reinforced degree of protection: IP 67



T12AF02

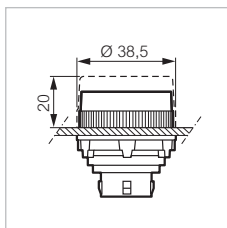

Supplied with opaque shroud

- Red
- Green
- Black
- Yellow

T12AF01
T12AF02
T12AF03
T12AF04

SPRING RETURN - FLUSH

Reinforced degree of protection: IP 67



T12AG03

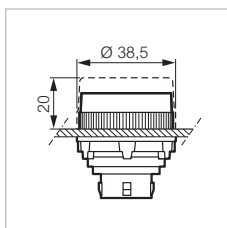

Supplied with transparent shroud
Marking possible
(engravings and symbols p. 118 and p. 72)

- Red
- Green
- Black
- Yellow
- White
- Blue

T12AG01
T12AG02
T12AG03
T12AG04
T12AG05
T12AG06

SPRING RETURN - PROJECTING



T16AB01

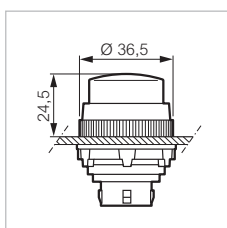

- Red
- Green
- Black
- Yellow
- White
- Blue

T16AB01
T16AB02
T16AB03
T16AB04
T16AB05
T16AB06

Separate units \varnothing 30: Heads

IP 65

To be combined with a clip and electrical blocks (p. 48)

With locking ring

Plastic chrome bezel- Other bezel on request (form p. 117)

\varnothing 30 blocks use the same blocks and clips (except for the 5 position clip) as \varnothing 22 mm heads (see p. 48-65)

Conform to IEC 60947-5-1



Characteristics (p. 121)

► PUSH-BUTTONS - NON ILLUMINATED (CONTINUED)

SPRING RETURN - MUSHROOM HEAD \varnothing 40

Push

Cat. No.

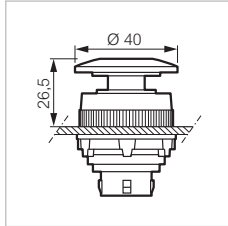

- Red
- Green
- Black
- Yellow

- T16AD01
- T16AD02
- T16AD03
- T16AD04

T16AD01

SPRING RETURN - MUSHROOM HEAD \varnothing 70

Push

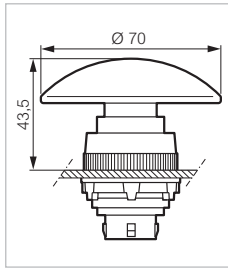

- Red - plastic
- Black - plastic
- Red - metallic

- T16AE01
- T16AE03
- T16AT01

T16AE01

SPRING RETURN - FLUSH-FLUSH

Double touch

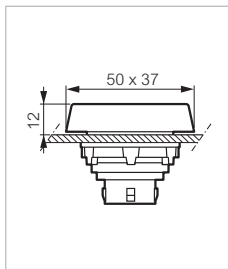

Plastic black frame

- Green
- Red
- Black
- Red

- T52QA02
- T52QA03

T52QA02

STAY-PUT - PROJECTING

Push-push

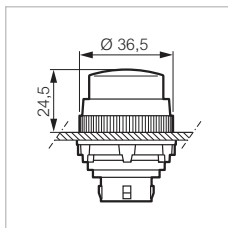

- Red
- Green
- Black
- Yellow
- White
- Blue

- T16CB01
- T16CB02
- T16CB03
- T16CB04
- T16CB05
- T16CB06

T16CB02

Separate units \varnothing 30: Heads

IP 65

To be combined with a clip and electrical blocks (p. 48)

With locking ring

Plastic chrome bezel- Other bezel on request (form p. 117)

\varnothing 30 blocks use the same blocks and clips (except for the 5 position clip) as \varnothing 22 mm heads (see p. 48-65)

Conform to IEC 60947-5-1



Characteristics (p. 121)

▶ SELECTOR SWITCHES - NON ILLUMINATED

WITH HANDLE

2 positions

Cat. No.



T16KA03

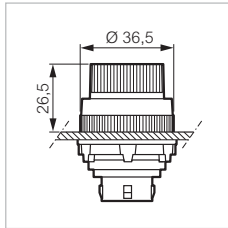

Stay-put positions - 45°

- Red
- Black
- Grey



T16KA01
T16KA03
T16KA08

Stay-put positions - 45°

- Red
- Black
- Grey



T16KC01
T16KC03
T16KC08

Spring return- 45°

- Red
- Black
- Grey



T16KD01
T16KD03
T16KD08

Stay-put positions - 90°

- Red
- Black
- Grey



T16KF01
T16KF03
T16KF08

WITH HANDLE

3 positions



T16MA01

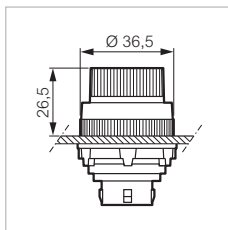

Stay-put positions - 45°

- Red
- Black
- Grey

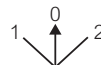

T16MA01
T16MA03
T16MA08

Spring return from right to 0 - 45°

- Red
- Black
- Grey



T16MC01
T16MC03
T16MC08

Spring return to 0 - 45°

- Red
- Black
- Grey



T16MD01
T16MD03
T16MD08

Stay-put positions - 90°

- Red
- Black
- Grey



T16MK01
T16MK03
T16MK08

Separate units \varnothing 30: Heads

IP 65

To be combined with a clip and electrical blocks (p. 48)

With locking ring

Plastic chrome bezel- Other bezel on request (form p. 117)

\varnothing 30 blocks use the same blocks and clips (except for the 5 position clip) as \varnothing 22 mm heads (see p. 48-65)

Conform to IEC 60947-5-1



Characteristics (p. 121)

▶ SELECTOR SWITCHES - NON ILLUMINATED (CONTINUED)

WITH LONG HANDLE

2 positions

Cat. No.



T16KP03

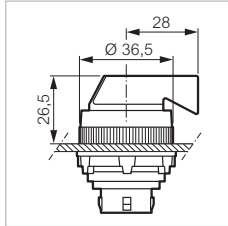

Stay-put positions - 45°

- Red
- Black
- Grey



T16KP01
T16KP03
T16KP08

Stay-put positions - 45°

- Red
- Black
- Grey



T16KR01
T16KR03
T16KR08

Spring return - 45°

- Red
- Black
- Grey



T16KS01
T16KS03
T16KS08

WITH LONG HANDLE

3 positions



T16MR01

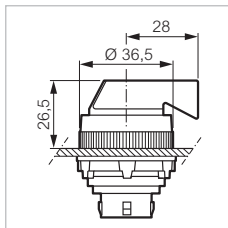

Stay-put positions - 45°

- Red
- Black
- Grey

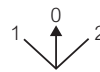

T16MR01
T16MR03
T16MR08

Spring return from right to 0 - 45°

- Red
- Black
- Grey



T16MT01
T16MT03
T16MT08

Spring return to 0 - 45°

- Red
- Black
- Grey



T16MU01
T16MU03
T16MU08

Separate units \varnothing 30: Heads

IP 65
 To be combined with a clip and electrical blocks (p. 48)
 With locking ring
 Plastic chrome bezel- Other bezel on request (form p. 117)
 \varnothing 30 blocks use the same blocks and clips (except for the 5 position clip) as \varnothing 22 mm heads (see p. 48-65)
 Conform to IEC 60947-5-1



Characteristics (p. 121)

▶ SELECTOR SWITCHES - NON ILLUMINATED (CONTINUED)

WITH KEY

2 positions

Cat. No.



T16LA00

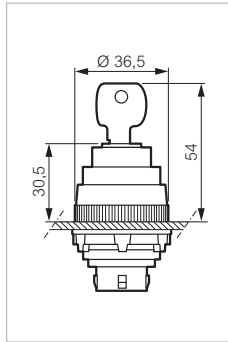

Supplied with 2 keys profile n° 455

Key free in position:

Stay-put positions - 45°

● Black



0

T16LA00

Stay-put positions - 45°

● Black



0

T16LC00

Spring return- 45°

● Black



0

T16LD00

Stay-put positions - 90°

● Black



0

T16LF00

Key profile n° 1424 and others (form p. 79)

WITH KEY

3 positions



T16NA00

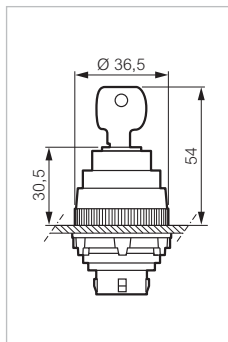

Supplied with 2 keys profile n° 455

Key free in position:

Stay-put positions - 45°

● Black



0

T16NA00

Spring return from right to 0 - 45°

● Black



0

T16NC00

Spring return to 0 - 45°

● Black



0

T16ND00

Stay-put positions -90°

● Black



1 - 0 - 2

T16NK00

Key profile n° 1424 and others (form p. 79)

Separate units Ø 30: Heads

IP 65
 To be combined with a clip and electrical blocks (p. 48)
 With locking ring
 Plastic chrome bezel- Other bezel on request (form p. 117)
 Ø 30 blocks use the same blocks and clips (except for the 5 position clip) as Ø 22 mm heads (see p. 48-65)
 Conform to IEC 60947-5-1



Characteristics (p. 121)

▶ SELECTOR SWITCHES - NON ILLUMINATED (CONTINUED)

WITH KEY

Push

Cat. No.



T16GM00

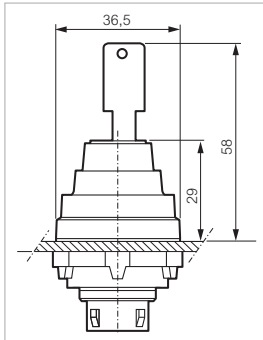

Supplied with 2 keys profile n° 455

Lockable position	Key free in:	
Stay-put		
In bottom position	Top and bottom position	T16GM00
Manual locking		
In top position	Top and bottom position	T16GF00
In top position	Bottom position	T16GJ00
In bottom position	Top and bottom position	T16GG00
In bottom position	Bottom position	T16GK00
In top and bottom position	Top and bottom position	T16GH00
In top and bottom position	Bottom position	T16GL00

Separate units \varnothing 30: Heads

IP 65

To be combined with a clip and electrical blocks (p. 48)

With locking ring

Plastic chrome bezel - Other bezel on request (form p. 117)

\varnothing 30 blocks use the same blocks and clips (except for the 5 position clip) as \varnothing 22 mm heads (see p. 48-65)

Conform to IEC 60947-5-1



Characteristics (p. 121)

► MUSHROOM HEADS - NON ILLUMINATED

\varnothing 40 - STAY-PUT

Push-pull to reset

Cat. No.

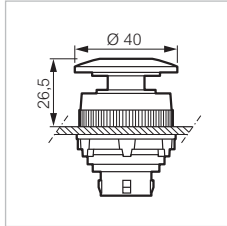

- Red
- Green
- Black
- Yellow

- T16DD01
- T16DD02
- T16DD03
- T16DD04

T16DD01

\varnothing 40 - STAY-PUT

Push-turn to reset

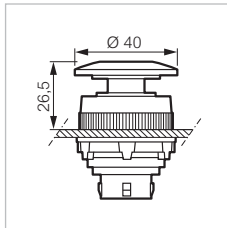

Stay-put

- Red
- Green
- Black
- Yellow

- T16ED01
- T16ED02
- T16ED03
- T16ED04

T16ED01

Manual locking

- Red
- Green
- Black
- Yellow

- T16FD01
- T16FD02
- T16FD03
- T16FD04

\varnothing 40 - STAY-PUT

Key to reset

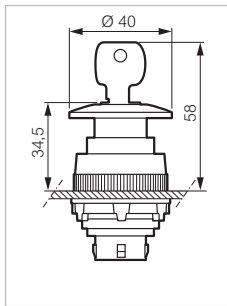
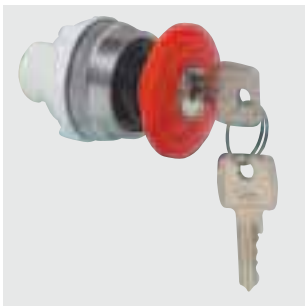

Supplied with 2 keys profile n° 455

- Red

T16GM01

T16GM01

\varnothing 70 - STAY-PUT

Key to reset

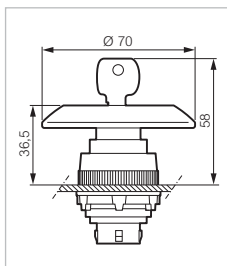

Supplied with 2 keys profile n° 455

- Red

T16GP01

T16GP01

Separate units \varnothing 30: Heads

IP 65
 To be used without electrical block
 Black plastic bezel
 Stroke 12 mm
 Conform to IEC 60947-5-1



Characteristics (p. 121)

► ADJUSTABLE MECHANICAL PUSH/RESET BUTTON - NON ILLUMINATED

SPRING RETURN - FLUSH

Cat. No.



T12HA04

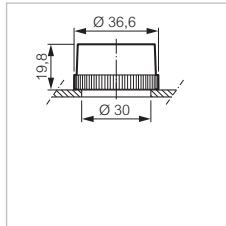

- Red
- Green
- Black
- Yellow
- White
- Blue

- T12HA01
- T12HA02
- T12HA03
- T12HA04
- T12HA05
- T12HA06

SPRING RETURN - FLUSH

Reinforced degree of protection: IP 67

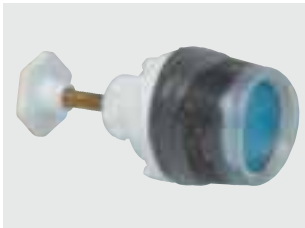

T12HG06

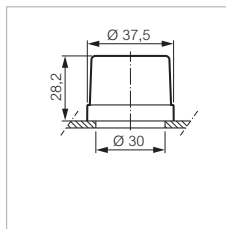

Supplied with transparent shroud

- Red
- Green
- Black
- Yellow
- White
- Blue

- T12HG01
- T12HG02
- T12HG03
- T12HG04
- T12HG05
- T12HG06

SPRING RETURN - PROJECTING



T12HB05

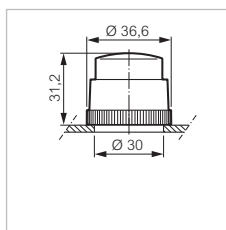

- Red
- Green
- Black
- Yellow
- White
- Blue

- T12HB01
- T12HB02
- T12HB03
- T12HB04
- T12HB05
- T12HB06

Separate units \varnothing 30: Heads

IP 65

To be combined with a clip and electrical blocks (p. 48)

With locking ring

Plastic chrome bezel- Black bezel on request (form p. 117)

\varnothing 30 blocks use the same blocks and clips (except for the 5 position clip) as \varnothing 22 mm heads (see p. 48-65)

Conform to IEC 60947-5-1



Characteristics (p. 121)

► PUSH-BUTTONS - ILLUMINATED

SPRING RETURN - FLUSH

Cat. No.



T16AH20

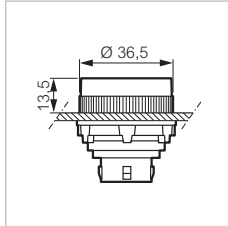

- Red
- Green
- Colourless
- Yellow
- Opal

T16AH10
T16AH20
T16AH30
T16AH40
T16AH50

SPRING RETURN - FLUSH

Reinforced degree of protection: IP 67



T12AP40

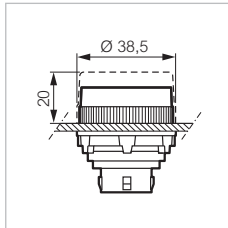

Supplied with transparent shroud

- Red
- Green
- Colourless
- Yellow
- Opal

T12AP10
T12AP20
T12AP30
T12AP40
T12AP50

Enables engraving of button plate (form p. 117)

SPRING RETURN - PROJECTING



T16AK10

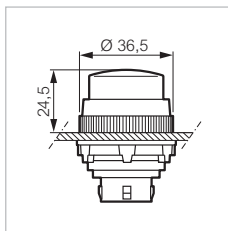

- Red
- Green
- Colourless
- Yellow
- Opal

T16AK10
T16AK20
T16AK30
T16AK40
T16AK50

SPRING RETURN - MUSHROOM HEAD \varnothing 40

Push



T16AM10

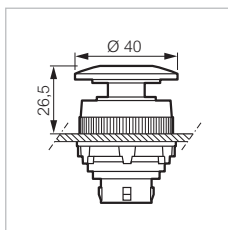

- Red
- Green
- Yellow
- Opal

T16AM10
T16AM20
T16AM40
T16AM50

Separate units \varnothing 30: Heads

IP 65

To be combined with a clip and electrical blocks (p. 48)

With locking ring

Plastic chrome bezel- Black bezel on request (form p. 117)

\varnothing 30 blocks use the same blocks and clips (except for the 5 position clip) as \varnothing 22 mm heads (see p. 48-65)

Conform to IEC 60947-5-1



Characteristics (p. 121)

► PUSH-BUTTONS - ILLUMINATED (CONTINUED)

STAY-PUT - PROJECTING

Push-push

Cat. No.



T16CK30

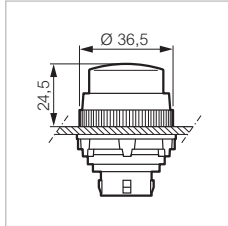

- Red
- Green
- Colourless
- Yellow
- Opal

- T16CK10
- T16CK20
- T16CK30
- T16CK40
- T16CK50

Separate units \varnothing 30: Heads

IP 65

To be combined with a clip and electrical blocks (p. 48)

With locking ring

Plastic chrome bezel- Other bezel on request (form p. 117)

\varnothing 30 blocks use the same blocks and clips (except for the 5 position clip) as \varnothing 22 mm heads (see p. 48-65)

Conform to IEC 60947-5-1



Characteristics (p. 121)

▶ SELECTOR SWITCHES - ILLUMINATED

WITH HANDLE

2 positions

Cat. No.



T16KG10

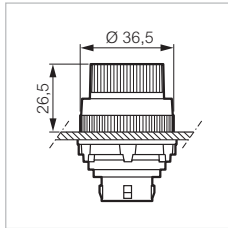

Stay-put positions - 45°

- Red
- Green
- Opal



T16KG10
T16KG20
T16KG50

Stay-put positions - 45°

- Red
- Green
- Opal



T16KJ10
T16KJ20
T16KJ50

Spring return - 45°

- Red
- Green
- Opal



T16KK10
T16KK20
T16KK50

Stay-put positions - 90°

- Red
- Green
- Opal



T16KM10
T16KM20
T16KM50

WITH HANDLE

3 positions



T16ME20

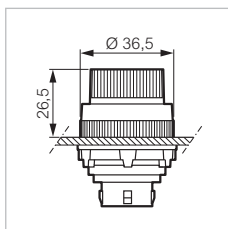

Stay-put positions - 45°

- Red
- Green
- Opal

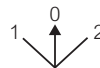

T16ME10
T16ME20
T16ME50

Spring return from right to 0 - 45°

- Red
- Green
- Opal



T16MG10
T16MG20
T16MG50

Spring return to 0 - 45°

- Red
- Green
- Opal



T16MH10
T16MH20
T16MH50

Stay-put positions - 90°

- Red
- Green
- Opal



T16MJ10
T16MJ20
T16MJ50

Separate units \varnothing 30: Heads

To be combined with a clip and electrical blocks (p. 48)
 With locking ring
 For lens engraving (form p. 117)
 Conform to IEC 60947-5-1



Characteristics (p. 121)

▶ PILOT LIGHT

LENS WITH BEZEL

Cat. No.



T10SB50V

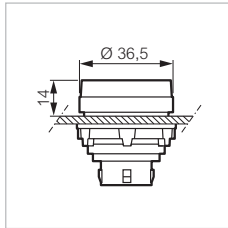

Smooth lens

- Red
- Green
- Colourless
- Yellow
- Opal
- Blue

- T10SB10V
- T10SB20V
- T10SB30V
- T10SB40V
- T10SB50V
- T10SB60V

LENS WITH BEZEL AND TRIM



T15SB20V

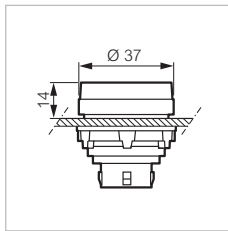

Smooth lens

- Red
- Green
- Colourless
- Yellow
- Opal
- Blue

- T15SB10V
- T15SB20V
- T15SB30V
- T15SB40V
- T15SB50V
- T15SB60V

Accessories ø 30

 Characteristics (p. 121)

▶ COMPLETE FRAME

Standard model

Cat. No.



UP39

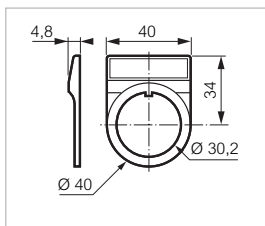

Round shape
Black frame and legend plate unassembled
2 lines maximum, 18 characters per line

Without engraving

- Red
- Black
- Alu
- Transparent

UP31
UP33
UP39
UP37

On demand engraving (p. 117)

Large model



UG39

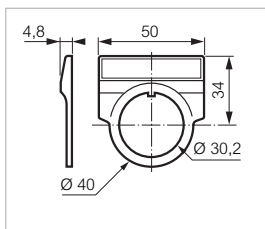

Round shape
Black frame and legend plate unassembled
2 lines maximum, 24 characters per line

Without engraving

- Red
- Black
- Alu
- Transparent

UG31
UG33
UG39
UG37

On demand engraving (p. 117)

▶ LEGEND PLATE

Standard model

Cat. No.



IB1

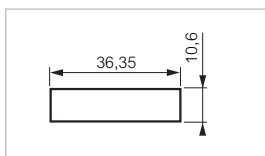

2 lines maximum, 18 characters per line
For frame cat. no.. UP3

Without engraving

- Red
- Black
- Alu
- Transparent

IB1
IB3
IB9
IB7

On demand engraving (p. 117)

Cardboard legend for transparent legend plate
Sheet of 20 pieces, to be cut out

I2B

Accessories ø 30

 Characteristics (p. 121)

▶ LEGEND PLATE (CONTINUED)

Large model

Cat. No.



IC3

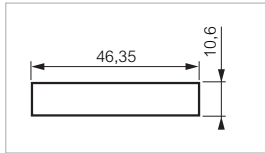

2 lines maximum, 24 characters per line
For frame cat. no.. UG3

Without engraving

- Red IC1
- Black IC3
- Alu IC9
- Transparent IC7

On demand engraving (p. 117)

Cardboard legend for transparent legend plate I2C
Sheet of 20 pieces, to be cut out

▶ FRAMES

Standard model

Cat. No.



UP3

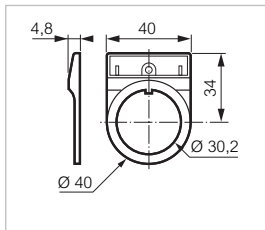

- Black UP3

Large model



UG3

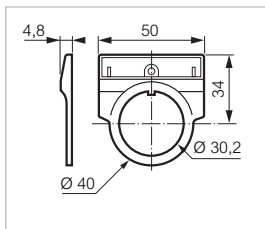

- Black UG3

Accessories ø 30

 Characteristics (p. 121)

▶ BUTTON PLATES

FOR ILLUMINATED FLUSH BUTTONS

Cat. No.

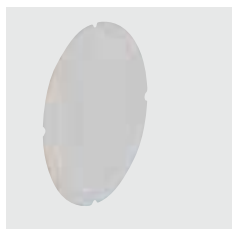

UE02

2 lines maximum, 10 characters per line
To be inserted under the button

Without engraving

- Transparent

UE02

On demand engraving (p. 70)

Symbol code to be added at the end of the catalogue number

- Transparent (black engraving)

UE0□□□

Other colours (form p. 117)

FOR PILOT LIGHTS



UE10

2 lines maximum, 12 characters per line
To be inserted under the lens

Without engraving

- Transparent

UE10

On demand engraving (p. 70)

Symbol code to be added at the end of the catalogue number

- Transparent (black engraving)

UE10□□□

▶ SHROUDS IP 67

FOR ADJUSTABLE MECHANICAL BUTTONS

Cat. No.



UA0219

- Transparent

UA0219

FOR FLUSH BUTTONS



UA0228

- Red
- Green
- Black
- Yellow
- Transparent

UA0203
UA0204
UA0205
UA0206
UA0228

Accessories ø 30

 Characteristics (p. 121)

▶ BEZELS

ROUND

Cat. No.



UA0011

Height 13 mm
Possibility of sticking the bezel on the button
(add code YO91 at the end of the catalogue number)

Brilliant chrome plastic	UA0011
Black plastic	UA0012
Grey plastic	UA0013
Matt chrome plastic bezel	UA0016
Matt chrome brass	UA0014

For adjustable mechanical button



UA0112

Height 20 mm

Brilliant chrome plastic	UA0111
Black plastic	UA0112
Grey plastic	UA0113
Brilliant chrome brass	UA0114

GUARD

For flush push-buttons



UA0202

Height 20 mm

Brilliant chrome brass	UA0202
------------------------	--------

Accessories ϕ 30

 Characteristics (p. 121)

► MISCELLANEOUS

FIXING TOOL

Cat. No.



Fixing tool ϕ 30

WA0210

WA0210

BLANKING PLUG



Grey

UA0215

UA0215

ANTI-ROTATION RING



Anti-rotation ring













UA0209

UA0209

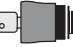
Request form for specific control and signalling units ø 30

▶ HEAD (fill in one form for each type of product)

Type:

-  Spring return flush
-  Spring return projecting
-  Mushroom head spring return
-  Push-push stay-put
-  Push-push super flush
-  Mushroom head push-pull stay-put
-  Mushroom head push-turn stay-put
-  Mushroom head With key
-  Selector switch handle
-  Selector switch with long handle
-  Selector switch with key
 - 455
 - 1421 A
 - Other
-  Double touch
-  Mechanical button
 - Flush
 - Projecting
-  Pilot light

Options:

- Illuminated button
- IP 67 shroud
- Guard for buttons

Size (mm):

- Mushroom head Ø 40 Ø 70

Colour :

- Colourless Green
- Black Red
- Opal Blue
- Yellow

Bezel:

- black
- grey
- matt chromed
- brilliant chromed
- chromed brass

▶ ENGRAVINGS

Use the grid below

- on head**
 - standard text or symbol
 - other text (2 x 10 characters)
- on legend plate :**
 - standard (2 x 18 characters)
 - large model (2 x 14 characters)
- Ground colour:
 - white
 - alu
 - black

▶ BLOCKS AND CLIPS

Block:

- ① NO
- ② NC
- ③ NO/NC
- ④ Transformer
- ⑤ Filter
- ⑥ Junction
- ⑦ Empty
- ⑧ Lamp-test
- ⑨ LED



- Voltage: 24 V 130 V 230 V

- Colour: white yellow red green blue

Connection:

- Screw
- Faston
- Plug-in
- For PCB

Clips :

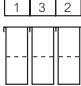
- 1 position 
- 3 positions 
- 5 positions 
- 6 positions 

Options:

- Head, block and clip assembled

YOUR DETAILS

Company:

.....

Name and surname:

.....

Address:

.....

E-mail :

Tel.:

Fax:

COMMENTS

ENGRAVING

▶ SELECTOR SWITCHES SWITCHING ANGLE

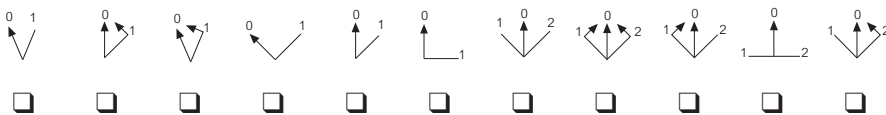

Key free in position: 0 1 2 other (attach diagram)

Engravings

Symbol code to be added at the end of the catalogue number

▶ STANDARD TEXTS

UNIVERSAL TEXT

Cat. No.

For selector switches and legend plates

O-I	081
I-II	082
I-O-I	091
I-II-III	092
O-I-START	093
O-I-II	094

ENGLISH TEXT

For buttons, pilot lights and legend plates

CLOSE	314
DOWN	336
FAST	310
FORWARD	305
INCH	329
JOG	328
LEFT	311
LOWER	308
OFF	304
ON	303
OPEN	313
POWER-ON	330
RAISE	307
RESET	315
REVERSE	306
RIGHT	312
RUN	327
SLOW	309
START	301
STOP	302
UP	335

For selector switches and legend plates

FORW.-OFF-REV.	392
HAND-AUTO	383
HAND-OFF-AUTO	391
LOCAL-OFF-REMOTE	393
OFF-ON	382
STOP-START	381

Engravings

Symbol code to be added at the end of the catalogue number

▶ STANDARD TEXTS (CONTINUED)

GERMAN TEXT

Cat. No.

For buttons, pilot lights and legend plates

AB	208
AUF	207
AUS	204
BETRIEB	224
BREMSEN	225
EIN	203
EINRICHTEN	223
FEINHEBEN	221
FEINSENKEN	222
HALT	202
HEBEN	219
LANGSAM	209
LINKS	211
RECHTS	212
RÜCKWÄRTS	206
SENKEN	220
SCHNELL	210
VORWÄRTS	205
VORRÜCKEN	226
ZU	214

For selector switches and legend plates

AUS-EIN	281
HAND-AUTO	283
HAND-O-AUTO	291
ZURÜCK-O-VOR	292

FRENCH TEXT

For buttons, pilot lights and legend plates

ALARME	133
ARRÊT	102
ARRÊT GÉNÉRAL	116
ARRIÈRE	106
AVANT	105
DÉCLENCHEMENT	131
DÉFAUT	132
DESCENTE	108
DROITE	112
EN SERVICE	103
FERMETURE	114
GAUCHE	111
HORS SERVICE	104
KLAXON	118
LENT	109
MARCHE	101
MONTÉE	107
OUVERTURE	113
RÉARMEMENT	115
SOUS TENSION	117
VITE	110

For selector switches and legend plates

ARRÊT-MARCHE	181
AVANT -O- ARRIÈRE	192
C.P.C.-NORMAL	184
HORS-EN	182
MANU-AUTO	183
MANU -O- AUTO	191

Panel cut-out $\varnothing 30$

DRILLING

For heads equipped with electrical blocks with screw terminals

Minimum interval (mm)

	> 40	For mushroom head $\varnothing 40$
A	> 50	For selector switch with Long handle
	> 70	For mushroom head $\varnothing 70$
	> 50	For double touch
B	> 50	For legend plates
	> 70	For mushroom head $\varnothing 70$

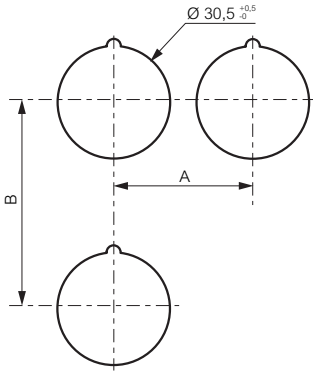

DRILLING WHEN USING THE ANTI-ROTATION RING (OPTIONAL)

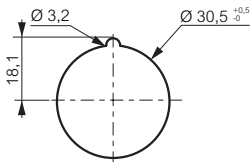

Technical characteristics \varnothing 30

► GENERAL

Characteristics	Data	Standards
► Storage temperature for illuminated or non illuminated button	- 40°C to + 70°C	
► Operating temperature	Non illuminated buttons: - 25°C to + 70°C Illuminated buttons: - 25°C to + 60°C	
► Degree of protection	IP 65 for standard heads IP 67 for shrouded heads	IEC 60947-1
► Mechanical life	Spring return push button: 3 x 10 ⁶ operating cycles	IEC 60947-5-1

The blocks used for diameter 30 are the same as for diameter 22.
Their characteristics are described on p. 95

► MOUNTING THE BLOCKS

